

# Afai Ships - Aquan (General Arrangement)



## Technical Specifications

Possible Configurations  
200 Pax

Deadweight (normal)  
20 tonnes

Length  
24m

Beam  
9m

Draft  
1.6m

Speed  
27 knots (light load)

Speed  
24 knots (full load)

Fuel Capacity  
9,000 litres

Engine  
2 x IF V1708 T2 (2 x 700kw)

Fuel Consumption  
345 l/hr

Other engine packages are available

Gearbox  
2 x ZF BW250

Propulsion  
2 x Fixed Pitch

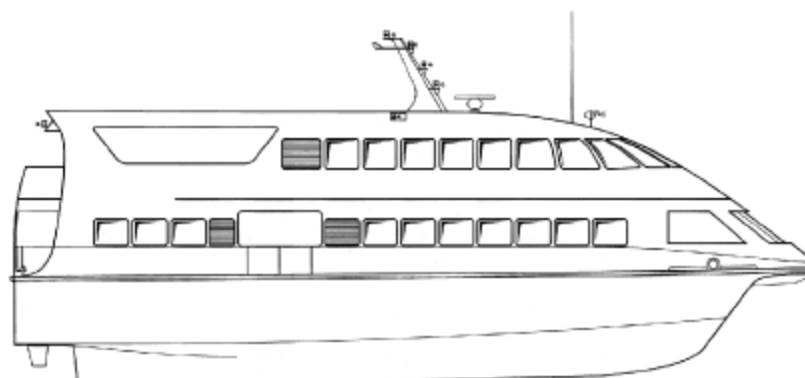

Outboard profile

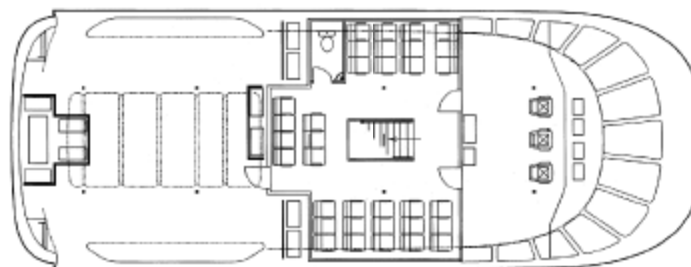

Upper Deck

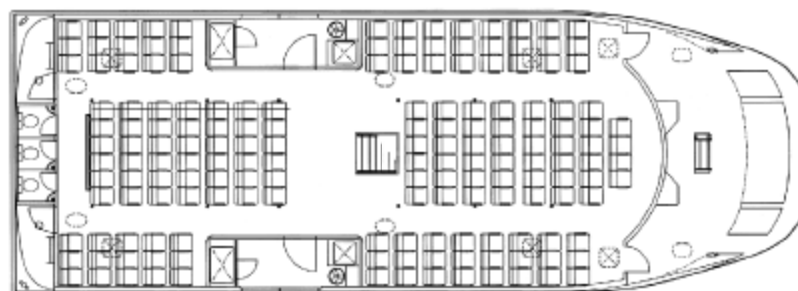

Main Deck